

# XEROX 9400 DUPLICATOR

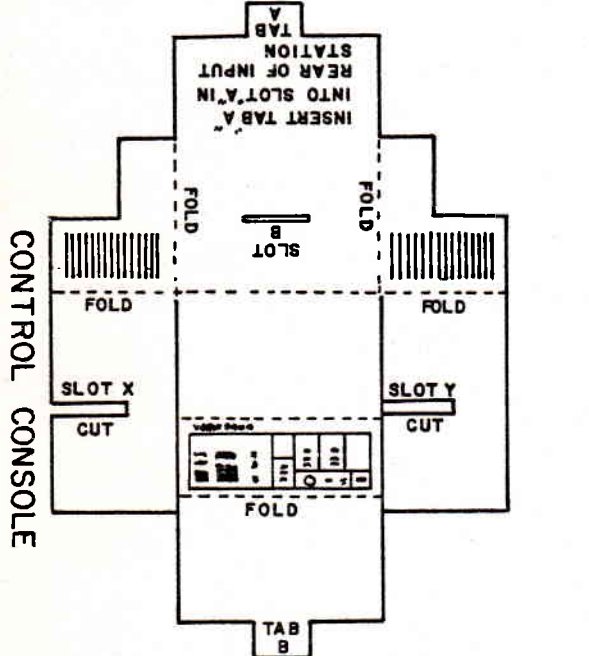

## CONTROL CONSOLE ASSEMBLY

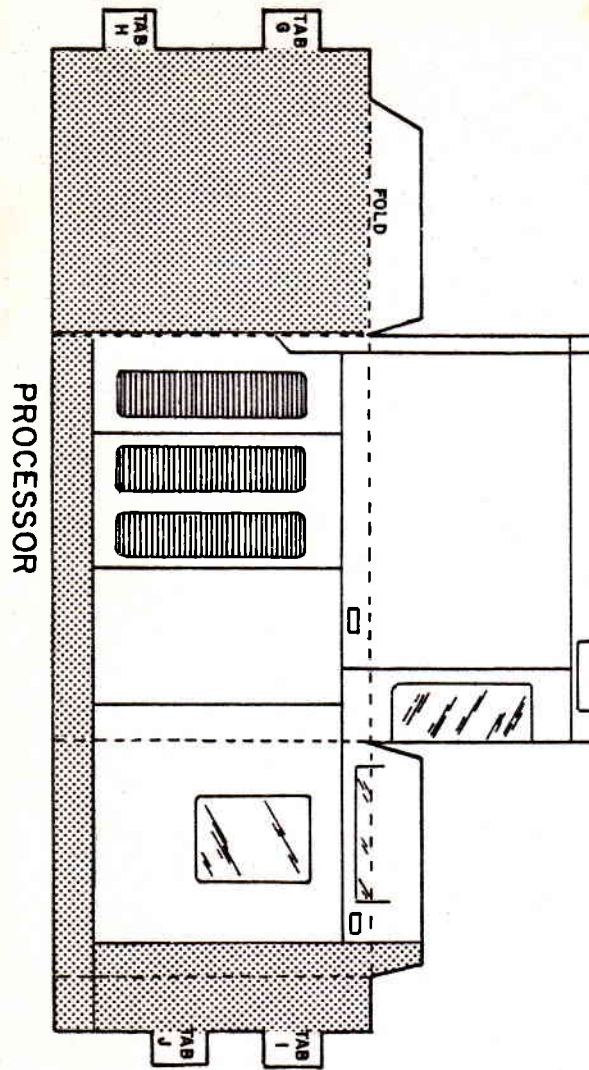
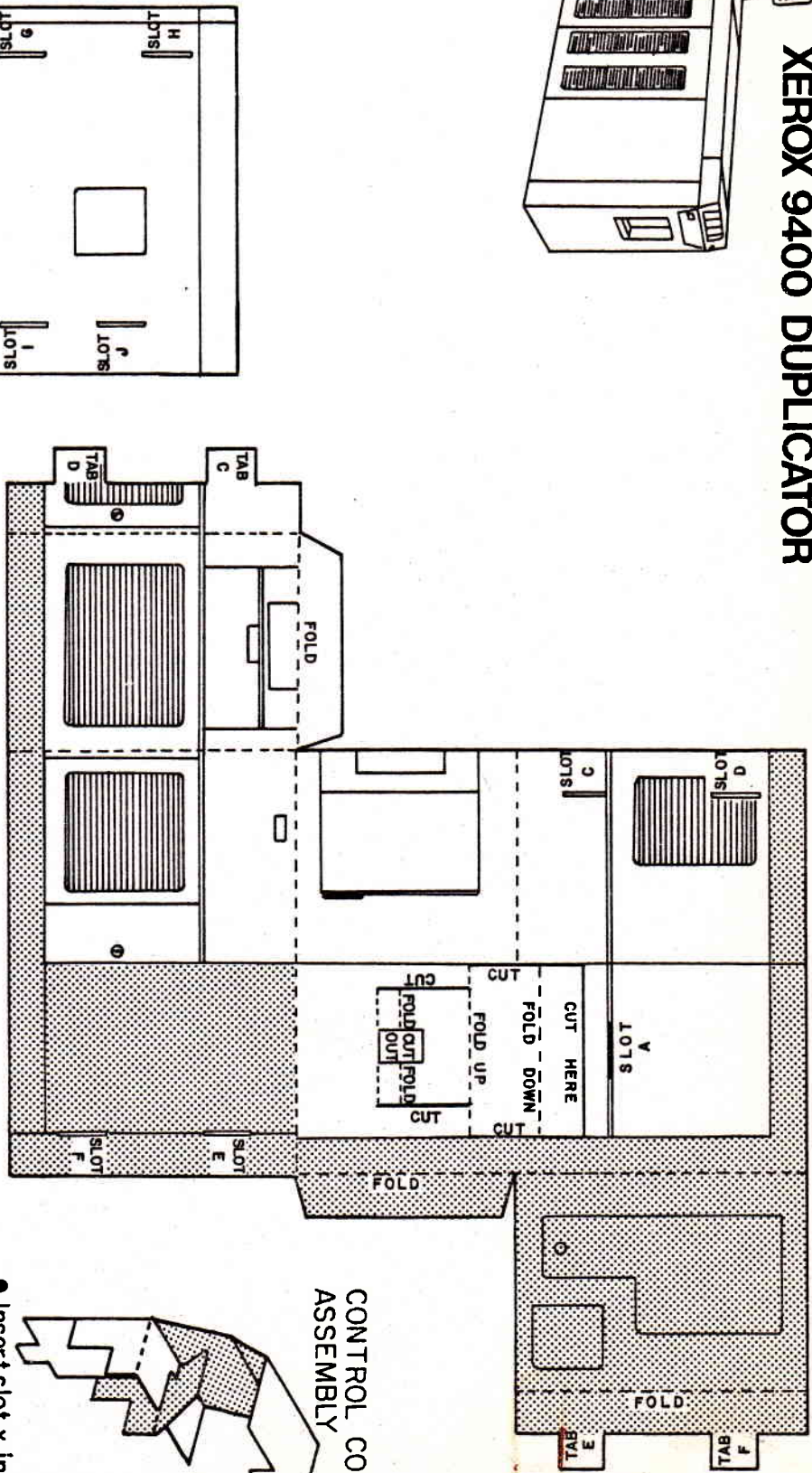
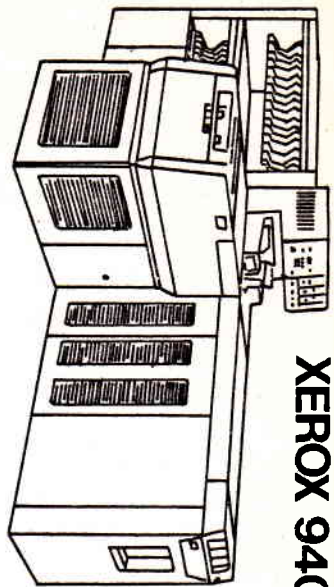
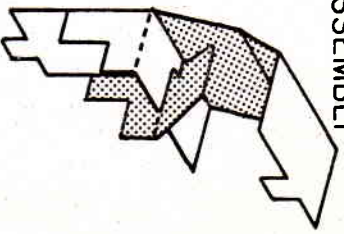

● Insert slot x into y

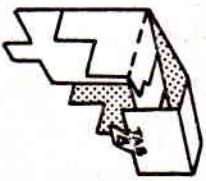

● Wrap top over interlocked tabs

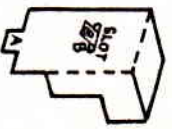

● Insert tab B thru slot B

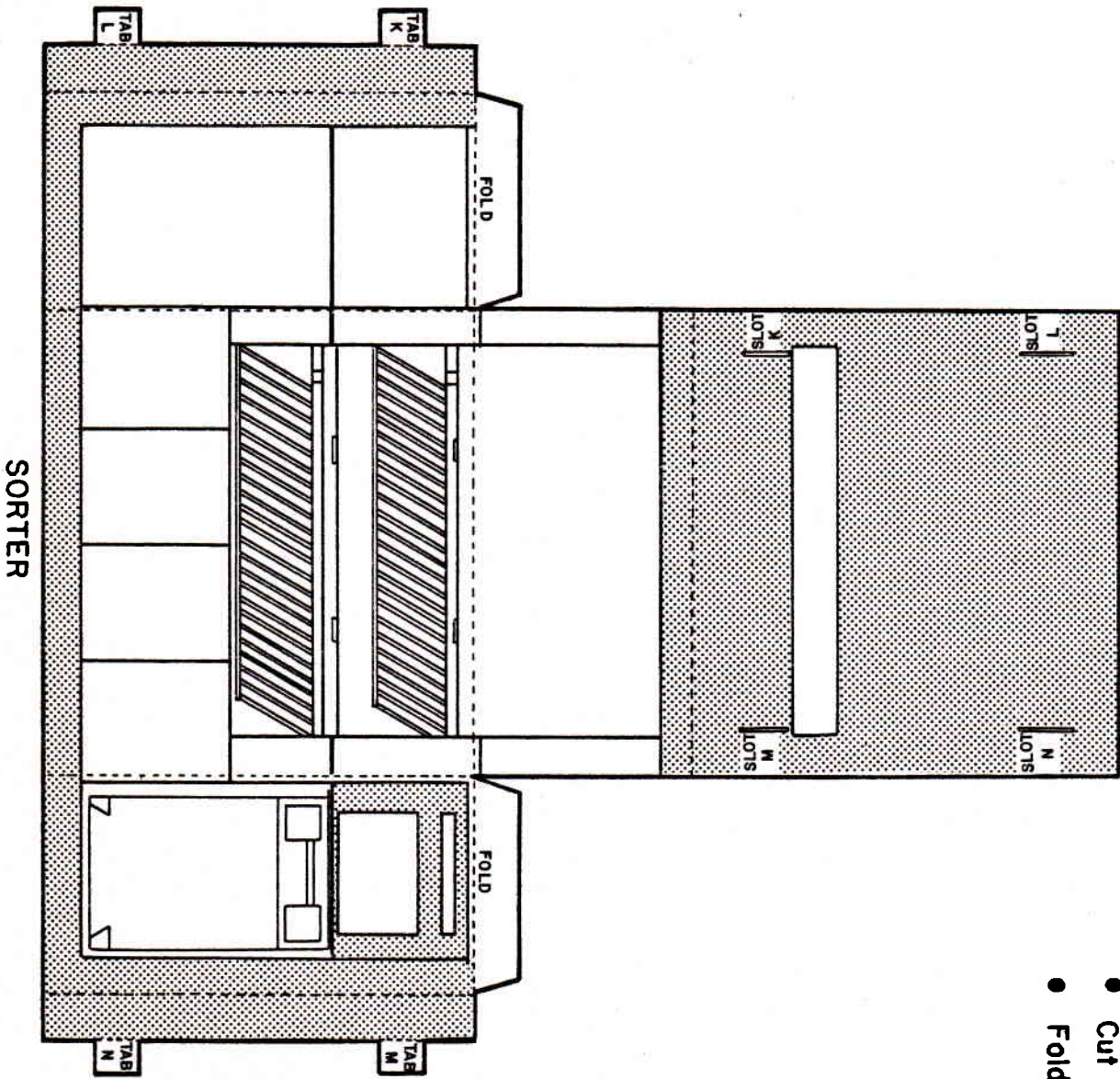

**INSTRUCTIONS**

- Cut out along heavy solid lines.
- Cut slots as indicated (A thru N)
- Fold on dotted lines

